

Rubinetto a sfera scarico caldaia Drain ball valve with brass hose connection

139

VOCI DI CAPITOLATO - TECHNICAL FEATURES



MISURA/SIZE	3/8" (DN 10)	1/2" (DN 15)	3/4" (DN 20)
PRESSIONE/PRESSURE	12bar/174psi	12bar/174psi	12bar/174psi
CODICE/CODE	1390038	1390012	1390034
IMBALLO/PACKING	20/200	20/200	15/120

Corpo in ottone.

Raccordo in ottone.

Temperature minima e massima d'esercizio:
-20°C, 110°C.

Attacco filettato ISO228

(equivalente a DIN EN ISO 228 e BS EN ISO 228).

Body in brass.

Hose connection in brass.

Minimum and maximum working temperatures:
-20°C, 110°C.

Threads ISO228

(equivalent to DIN EN ISO 228 and BS EN ISO 228).

QUOTE DI INGOMBRO - DRAWING

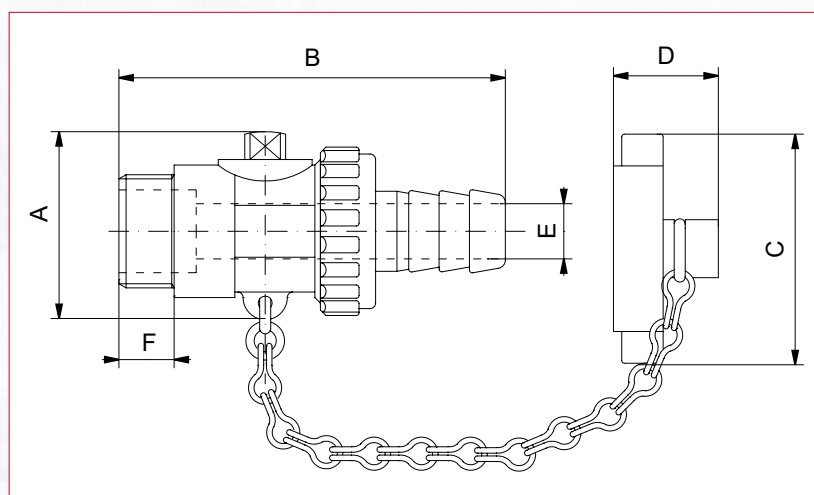

MISURE / SIZE	1/2"	3/4"	1"
DN	10	15	20
A (mm)	33	33	40
B (mm)	72	72	86
C (mm)	41	41	50
D (mm)	19	19	19
E (mm)	10	10	12
F (mm)	12	12	14
PRESS. ATMOSF. / WORK. PRESS. Kg/cm ² - bar	12	12	12
PRESS. ATMOSF. PSI LBS WORK. PRESS	170	170	170

SCHEDA MATERIALI - MATERIALS

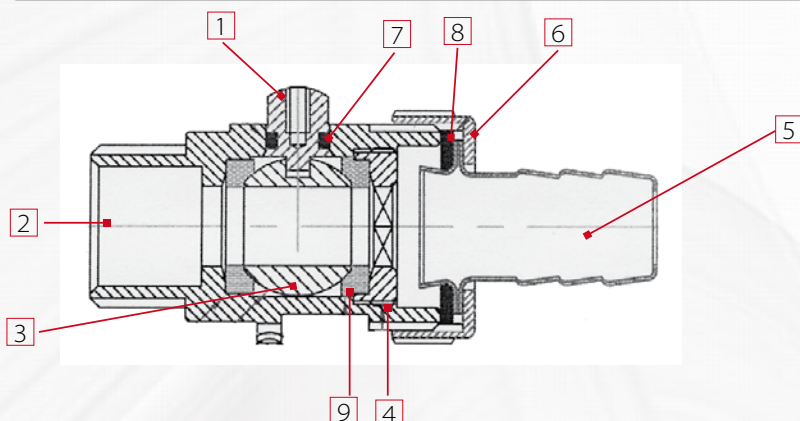

Q.TÀ/N.	MATERIALE/MATERIAL
1	Ottone CW614N / Brass
2	Ottone CW614N / Brass
3	Ottone CW614N / Brass
4	Ottone CW614N / Brass
5	Lamiera di ottone
6	Ottone CW617N / Brass
7	NBR 70
8	NBR 70
9	PTFE

Certificazioni- Certifications

